

INSTALLATION MANUAL

LISCIO FB SLIM MIRROR LUMINAIRE

- Liscio FB 228S
- Liscio FB 236S
- Liscio FB 214S
- Liscio FB 218S

INSTALLATION NOTICE

 **Warning**

- Please follow all the installation manual carefully. Any improper installation will cause burn, electrical shock and lamp malfunction.
- Please do not modify or change the actual part of the lamp
- Please ensure the incoming supply voltage in valid rating.
- If the lamp malfunction, please cut off the supply and call the qualified technician or the related store which sell this product.
- Please do not close this product with sound or heat prove material. 
- Please do not install this product near to the inflammable material.

 **Notice**

- Please do not install this product under direct sun reflected area, enclose with vaporized material & vibrating area.
- Please cut off the supply during the maintenance work.



Step 1 : Make holes at the four corners at the back of the housing as shown in the drawing. Size of the holes should be uniform at 2.0mm.

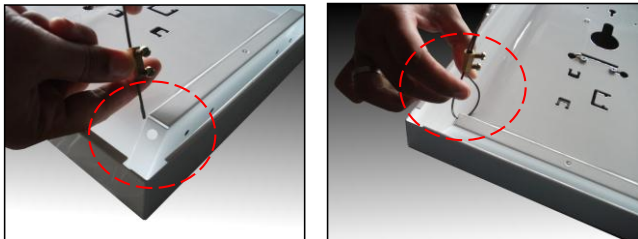

Step 2 : Insert stainless steel cables into each of the previously prepared four holes and then insert into cable locking device according to the picture above. Please make sure that the cable locking device is tightened properly.



Step 3 : Insert the supply cable into the frame and connect to the prepared connector



Step 4 : Fix lamp tube at the lampholder properly and rotate 90°.



Step 5 : Reattach the louvre to the lamp frame by pressing it towards the stainless steel clip.

