

INSTALLATION MANUAL

GALLIANO LED

- 226 HE / HO
- 218 HE / HO

INSTALLATION NOTICE

 **Warning**

- Please follow all the installation manual carefully. Any improper installation will cause burn, electrical shock and lamp malfunction.
- Please do not modify or change the actual part of the lamp
- Please ensure the incoming supply voltage in valid rating.
- If the lamp malfunction, please cut off the supply and call the qualified technician or the related store which sell this product.
- Please do not close this product with sound or heat prove material. 
- Please do not install this product near to the inflammable material.

 **Notice**

- Please do not install this product under direct sun reflected area, enclose with vaporized material & vibrating area.
- Please cut off the supply during the maintenance work.

Cara-Cara Memasang



- Galliano LED = Dia.

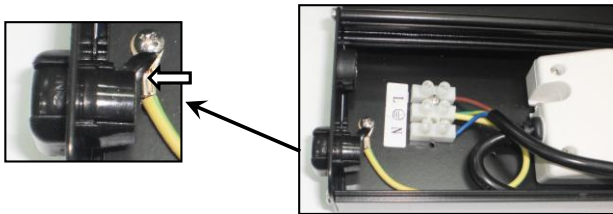

Step 1 : Push the pin inside the driver box to detach cable bush.

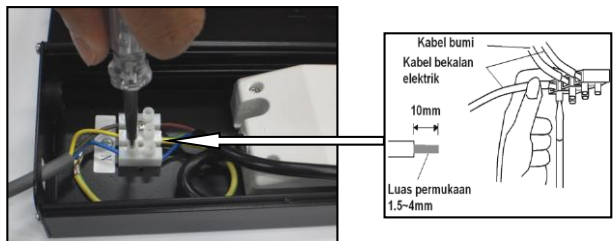

Step 2 : Insert supply cable into the driver box and connect to the prepared terminal block.

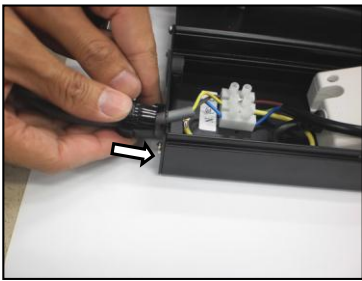

Step 3 : Attach back the cable bush with driver box.

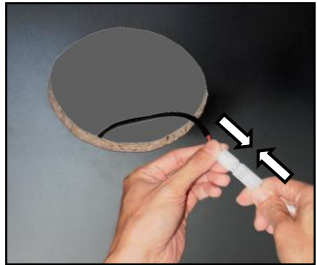

Step 4 : Connect the (male) connector from the transformer box to (female) connector from the lamp frame.



Step 5 : Insert the lamp frame into the ceiling hole and tighten both the screws according to the clockwise. Make sure the lamp cover is taken off before this step.



Step 6 : Insert the spring from the lamp cover into the hole on the lamp frame. Make sure that the lamp cover is placed properly.